

Specify Part No. by required I.D., O.D. and Length.
(e.g.) I.D. is 60mm, O.D. is 80mm, and length is 90mm.

FGB - 608090

Parts No.

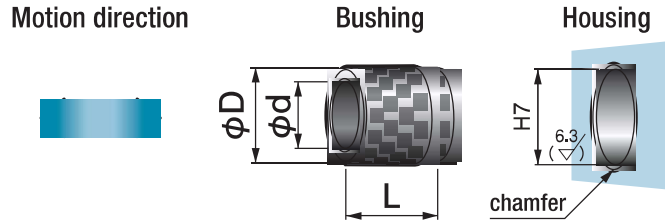

- 500F, is used as base steel.
- Applicable to reciprocating motion.
- It is recommended to use a set screw to prevent dislocation.

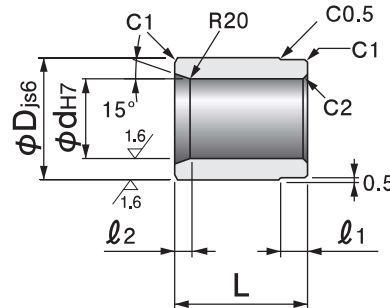

| Parts No. | I.D. | | O.D. | | Length | | l_1 | l_2 |
|----------------------|----------|------------|----------|--------------|--------|------------|-------|-------|
| | ϕd | Tolerance | ϕD | Tolerance | L | Tolerance | | |
| FGB-254040 | 25 | $+0.021_0$ | 40 | ± 0.008 | 40 | $0_{-0.2}$ | 10 | 5 |
| FGB-305050 | 30 | $+0.021_0$ | 50 | ± 0.008 | 50 | $0_{-0.2}$ | 10 | 5 |
| FGB-356055 | 35 | $+0.025_0$ | 60 | ± 0.0095 | 55 | $0_{-0.2}$ | 15 | 5 |
| FGB-406055 | 40 | $+0.025_0$ | 60 | ± 0.0095 | 55 | $0_{-0.2}$ | 15 | 5 |
| FGB-406060 | 40 | $+0.025_0$ | 60 | ± 0.0095 | 60 | $0_{-0.2}$ | 10 | 5 |
| FGB-507075 | 50 | $+0.025_0$ | 70 | ± 0.0095 | 75 | $0_{-0.2}$ | 15 | 10 |
| FGB-608090 | 60 | $+0.030_0$ | 80 | ± 0.0095 | 90 | $0_{-0.2}$ | 20 | 10 |
| FGB-80100120 | 80 | $+0.030_0$ | 100 | ± 0.011 | 120 | $0_{-0.2}$ | 25 | 10 |
| FGB-100120150 | 100 | $+0.035_0$ | 120 | ± 0.011 | 150 | $0_{-0.2}$ | 25 | 10 |
| FGB-120140180 | 120 | $+0.035_0$ | 140 | ± 0.0125 | 180 | $0_{-0.2}$ | 25 | 10 |

⚠ The dimensional tolerances are the values measured at +25°C.