

FWPT Oiles 500F SL1 Wear Plates

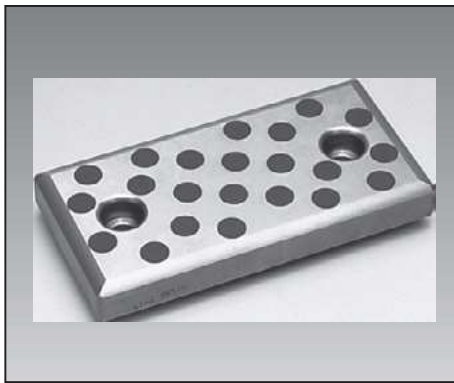

Specify Part No. by required width and length.
(e.g.) Width is 100mm and length is 100mm.

FWPT - 100100

Parts No.

Motion direction

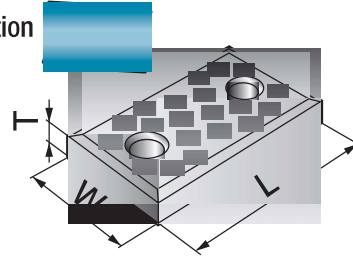

● 500F, is used as base steel.

Cross-section

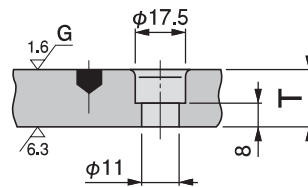
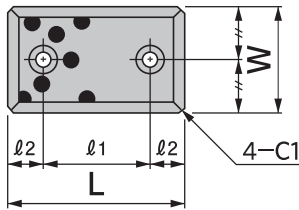

Chamfering

Type A

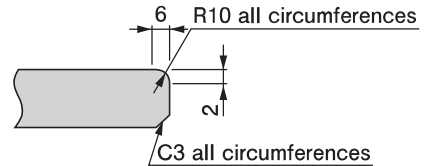

Parts No.	Width		Length		Thickness		Mounting hole intervals			Attach bolts		Chamfering
	W	Tolerance	L	Tolerance	T	Tolerance	ℓ ₁	Tolerance	ℓ ₂	Type	Qty	
FWPT-100100	100	-0.1 -0.3	100	-0.1 -0.3	20	±0.01	50	±0.2	25	M10 Hexagon socket head	2	A
FWPT-100125	100	-0.1 -0.3	125	-0.1 -0.3	20	±0.01	75	±0.2	25	M10 Hexagon socket head	2	A
FWPT-100150	100	-0.1 -0.3	150	-0.1 -0.3	20	±0.01	100	±0.2	25	M10 Hexagon socket head	2	A
FWPT-100200	100	-0.1 -0.3	200	-0.1 -0.3	20	±0.01	150	±0.2	25	M10 Hexagon socket head	2	A
FWPT-100250	100	-0.1 -0.3	250	-0.1 -0.3	20	±0.01	200	±0.2	25	M10 Hexagon socket head	2	A
FWPT-125125	125	-0.1 -0.3	125	-0.1 -0.3	20	±0.01	75	±0.2	25	M10 Hexagon socket head	2	A
FWPT-125150	125	-0.1 -0.3	150	-0.1 -0.3	20	±0.01	100	±0.2	25	M10 Hexagon socket head	2	A
FWPT-125200	125	-0.1 -0.3	200	-0.1 -0.3	20	±0.01	150	±0.2	25	M10 Hexagon socket head	2	A
FWPT-125250	125	-0.1 -0.3	250	-0.1 -0.3	20	±0.01	200	±0.2	25	M10 Hexagon socket head	2	A
FWPT-150150	150	-0.1 -0.3	150	-0.1 -0.3	20	±0.01	100	±0.2	25	M10 Hexagon socket head	2	A
FWPT-150200	150	-0.1 -0.3	200	-0.1 -0.3	20	±0.01	150	±0.2	25	M10 Hexagon socket head	2	A
FWPT-150250	150	-0.1 -0.3	250	-0.1 -0.3	20	±0.01	200	±0.2	25	M10 Hexagon socket head	2	A
FWPT-150300	150	-0.1 -0.3	300	-0.1 -0.3	20	±0.01	250	±0.2	25	M10 Hexagon socket head	2	A