

Specify Part No. by required I.D. and length.
(e.g.) I.D. is 8mm and length is 8mm.

HPF - 0808 Parts No.

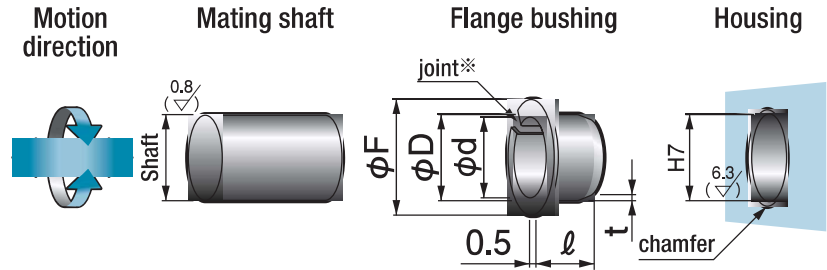

※The joint causes no influences upon rotation of the shaft. Be careful when press-fitting so that the joint is not at the position to which the maximum load is applied.

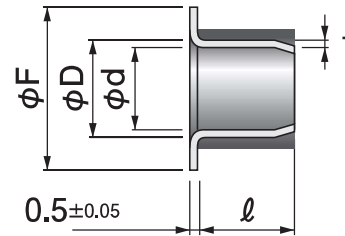

Shaft		I.D.	O.D.	Flange	Thickness		Length ℓ						I.D. tolerance after press fitting (reference)	
Size	Tolerance	ϕd	ϕD	ϕF	t	Tolerance	5	6	8	10	12	15		20
4	$\begin{matrix} -0.040 \\ -0.055 \end{matrix}$	4	5	8	0.5	± 0.05	0405							$\begin{matrix} +0.112 \\ -0.100 \end{matrix}$
5	$\begin{matrix} -0.040 \\ -0.055 \end{matrix}$	5	6	10	0.5	± 0.02	0505			0510				$\begin{matrix} +0.055 \\ -0.040 \end{matrix}$
6	$\begin{matrix} -0.040 \\ -0.055 \end{matrix}$	6	7	11	0.5	± 0.02		0606		0610				$\begin{matrix} +0.055 \\ -0.040 \end{matrix}$
8	$\begin{matrix} -0.040 \\ -0.055 \end{matrix}$	8	9	13	0.5	± 0.02			0808			0815		$\begin{matrix} +0.055 \\ -0.040 \end{matrix}$
10	$\begin{matrix} -0.040 \\ -0.058 \end{matrix}$	10	11	16	0.5	± 0.02				1010		1015		$\begin{matrix} +0.058 \\ -0.040 \end{matrix}$
12	$\begin{matrix} -0.040 \\ -0.058 \end{matrix}$	12	13	18	0.5	± 0.02					1212		1220	$\begin{matrix} +0.058 \\ -0.040 \end{matrix}$
15	$\begin{matrix} -0.040 \\ -0.058 \end{matrix}$	15	16	22	0.5	± 0.02						1515	1520	$\begin{matrix} +0.058 \\ -0.040 \end{matrix}$

※The HPF0405, HPF0505, HPF0510, HPF1515 and HPF1520 have straight flange bottoms.

※The I.D. tolerances after press fitting are the reference values measured in the condition where the bushings are inserted into the housings and in close contact with them.