

# CWX Oiles 2000 Wear Plates 10mm Thickness

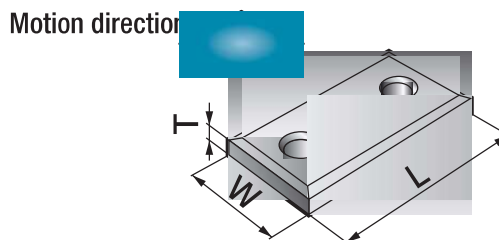

Specify Part No. by required width and length.  
(e.g.) Width is 75mm and length is 125mm.

**CWX - 75125**  
Parts No.



- Use the exclusive low-head bolt for mounting.  
(LHS-M1020 is attached to CWX series)

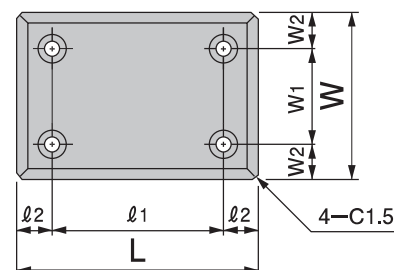
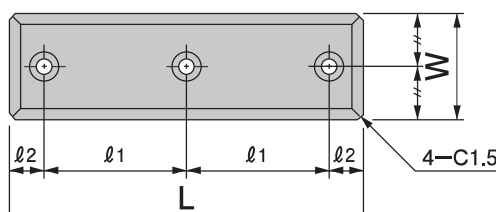
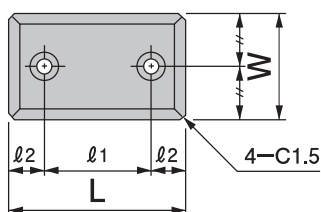

Parts No.	Width		Length		Thickness		Mounting hole intervals			No. of holes	Chamfering
	W	Tolerance	L	Tolerance	T	Tolerance	l <sub>1</sub>	Tolerance	l <sub>2</sub>		
<b>CWX-2875</b>	28	$-\frac{0.1}{-0.3}$	75	$-\frac{0.1}{-0.3}$	10	$\pm 0.01$	45	$\pm 0.2$	15	2	C
<b>CWX-28100</b>	28	$-\frac{0.1}{-0.3}$	100	$-\frac{0.1}{-0.3}$	10	$\pm 0.01$	50	$\pm 0.2$	25	2	C
<b>CWX-28125</b>	28	$-\frac{0.1}{-0.3}$	125	$-\frac{0.1}{-0.3}$	10	$\pm 0.01$	75	$\pm 0.2$	25	2	C
<b>CWX-28150</b>	28	$-\frac{0.1}{-0.3}$	150	$-\frac{0.1}{-0.3}$	10	$\pm 0.01$	100	$\pm 0.2$	25	2	C
<b>CWX-3875</b>	38	$-\frac{0.1}{-0.3}$	75	$-\frac{0.1}{-0.3}$	10	$\pm 0.01$	45	$\pm 0.2$	15	2	B
<b>CWX-38100</b>	38	$-\frac{0.1}{-0.3}$	100	$-\frac{0.1}{-0.3}$	10	$\pm 0.01$	50	$\pm 0.2$	25	2	B
<b>CWX-38125</b>	38	$-\frac{0.1}{-0.3}$	125	$-\frac{0.1}{-0.3}$	10	$\pm 0.01$	75	$\pm 0.2$	25	2	B
<b>CWX-38150</b>	38	$-\frac{0.1}{-0.3}$	150	$-\frac{0.1}{-0.3}$	10	$\pm 0.01$	100	$\pm 0.2$	25	2	B
<b>CWX-4875</b>	48	$-\frac{0.1}{-0.3}$	75	$-\frac{0.1}{-0.3}$	10	$\pm 0.01$	45	$\pm 0.2$	15	2	B
<b>CWX-48100</b>	48	$-\frac{0.1}{-0.3}$	100	$-\frac{0.1}{-0.3}$	10	$\pm 0.01$	50	$\pm 0.2$	25	2	B
<b>CWX-48125</b>	48	$-\frac{0.1}{-0.3}$	125	$-\frac{0.1}{-0.3}$	10	$\pm 0.01$	75	$\pm 0.2$	25	2	B
<b>CWX-48150</b>	48	$-\frac{0.1}{-0.3}$	150	$-\frac{0.1}{-0.3}$	10	$\pm 0.01$	100	$\pm 0.2$	25	2	B
<b>CWX-48200</b>	48	$-\frac{0.1}{-0.3}$	200	$-\frac{0.1}{-0.3}$	10	$\pm 0.01$	100	$\pm 0.2$	50	2	B
<b>CWX-48250</b>	48	$-\frac{0.1}{-0.3}$	250	$-\frac{0.1}{-0.3}$	10	$\pm 0.01$	100	$\pm 0.2$	25	3	B
<b>CWX-5875</b>	58	$-\frac{0.1}{-0.3}$	75	$-\frac{0.1}{-0.3}$	10	$\pm 0.01$	45	$\pm 0.2$	15	2	B
<b>CWX-58100</b>	58	$-\frac{0.1}{-0.3}$	100	$-\frac{0.1}{-0.3}$	10	$\pm 0.01$	50	$\pm 0.2$	25	2	B
<b>CWX-58150</b>	58	$-\frac{0.1}{-0.3}$	150	$-\frac{0.1}{-0.3}$	10	$\pm 0.01$	100	$\pm 0.2$	25	2	B
<b>CWX-7575</b>	75	$-\frac{0.1}{-0.3}$	75	$-\frac{0.1}{-0.3}$	10	$\pm 0.01$	25	$\pm 0.2$	25	2	A
<b>CWX-75100</b>	75	$-\frac{0.1}{-0.3}$	100	$-\frac{0.1}{-0.3}$	10	$\pm 0.01$	50	$\pm 0.2$	25	2	A
<b>CWX-75125</b>	75	$-\frac{0.1}{-0.3}$	125	$-\frac{0.1}{-0.3}$	10	$\pm 0.01$	75	$\pm 0.2$	25	2	A

**Chamfering**

**Type A**

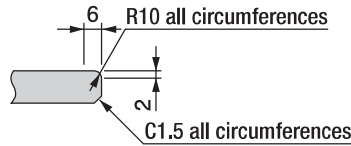

**Type B**

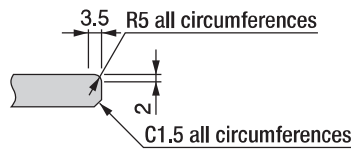

**Type C**

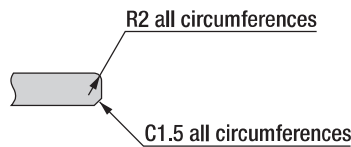

**Cross-section**

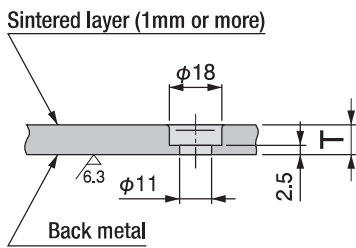

- LHS Exclusive Bolt for CWX  
[Parts No. : LHS-M1020]

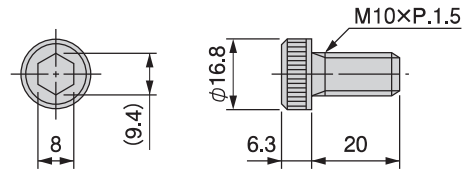

- Exclusive bolt LHS-M1020 is attached to CWX plate.
- The Exclusive bolt has approximate breaking torque of JIS standard M10 socket head cap screw.  
N · m {kgf · m}

Parts No.	LHS-M1020
Recommended tightening torque	67.3 {6.86}
Breaking torque	118 {12.0}

※Bolt itself is on sale.

Parts No.	Width		Length		Thickness		Mounting hole intervals					No. of holes	Chamfering	
	W	Tolerance	L	Tolerance	T	Tolerance	W <sub>1</sub>	Tolerance	W <sub>2</sub>	l <sub>1</sub>	Tolerance			l <sub>2</sub>
<b>CWX-75150</b>	75	$-0.1$ $-0.3$	150	$-0.1$ $-0.3$	10	$\pm 0.01$	—	—	—	100	$\pm 0.2$	25	2	A
<b>CWX-75200</b>	75	$-0.1$ $-0.3$	200	$-0.1$ $-0.3$	10	$\pm 0.01$	—	—	—	150	$\pm 0.2$	25	2	A
<b>CWX-75250</b>	75	$-0.1$ $-0.3$	250	$-0.1$ $-0.3$	10	$\pm 0.01$	—	—	—	100	$\pm 0.2$	25	3	A
<b>CWX-75300</b>	75	$-0.1$ $-0.3$	300	$-0.1$ $-0.3$	10	$\pm 0.01$	—	—	—	100	$\pm 0.2$	50	3	A
<b>CWX-100100</b>	100	$-0.1$ $-0.3$	100	$-0.1$ $-0.3$	10	$\pm 0.01$	50	$\pm 0.2$	25	50	$\pm 0.2$	25	4	A
<b>CWX-100125</b>	100	$-0.1$ $-0.3$	125	$-0.1$ $-0.3$	10	$\pm 0.01$	50	$\pm 0.2$	25	75	$\pm 0.2$	25	4	A
<b>CWX-100150</b>	100	$-0.1$ $-0.3$	150	$-0.1$ $-0.3$	10	$\pm 0.01$	50	$\pm 0.2$	25	100	$\pm 0.2$	25	4	A
<b>CWX-100200</b>	100	$-0.1$ $-0.3$	200	$-0.1$ $-0.3$	10	$\pm 0.01$	50	$\pm 0.2$	25	150	$\pm 0.2$	25	4	A
<b>CWX-100250</b>	100	$-0.1$ $-0.3$	250	$-0.1$ $-0.3$	10	$\pm 0.01$	50	$\pm 0.2$	25	200	$\pm 0.2$	25	4	A
<b>CWX-100300</b>	100	$-0.1$ $-0.3$	300	$-0.1$ $-0.3$	10	$\pm 0.01$	50	$\pm 0.2$	25	200	$\pm 0.2$	50	4	A
<b>CWX-125125</b>	125	$-0.1$ $-0.3$	125	$-0.1$ $-0.3$	10	$\pm 0.01$	75	$\pm 0.2$	25	75	$\pm 0.2$	25	4	A
<b>CWX-125150</b>	125	$-0.1$ $-0.3$	150	$-0.1$ $-0.3$	10	$\pm 0.01$	50	$\pm 0.2$	37.5	100	$\pm 0.2$	25	4	A
<b>CWX-125200</b>	125	$-0.1$ $-0.3$	200	$-0.1$ $-0.3$	10	$\pm 0.01$	50	$\pm 0.2$	37.5	150	$\pm 0.2$	25	4	A
<b>CWX-125250</b>	125	$-0.1$ $-0.3$	250	$-0.1$ $-0.3$	10	$\pm 0.01$	50	$\pm 0.2$	37.5	200	$\pm 0.2$	25	4	A
<b>CWX-125300</b>	125	$-0.1$ $-0.3$	300	$-0.1$ $-0.3$	10	$\pm 0.01$	50	$\pm 0.2$	37.5	200	$\pm 0.2$	50	4	A
<b>CWX-150150</b>	150	$-0.1$ $-0.3$	150	$-0.1$ $-0.3$	10	$\pm 0.01$	100	$\pm 0.2$	25	100	$\pm 0.2$	25	4	A
<b>CWX-150200</b>	150	$-0.1$ $-0.3$	200	$-0.1$ $-0.3$	10	$\pm 0.01$	100	$\pm 0.2$	25	150	$\pm 0.2$	25	4	A
<b>CWX-150250</b>	150	$-0.1$ $-0.3$	250	$-0.1$ $-0.3$	10	$\pm 0.01$	100	$\pm 0.2$	25	200	$\pm 0.2$	25	4	A